

6. Plastic and glass parts, which are breakable, are not covered under this warranty.
7. The appliances subjected to normal wear and tear, misuse, neglect, accident, including technical break down due to non-compliance of instructions given in the instruction manual, improper installation is not covered by this warranty.
8. All parts that may have been replaced shall become the property of the company.
9. Under the terms of warranty, servicing will be provided at the address registered by the consumer. The turn around time for technician to visit and resolve the complaint may vary, incase the service address is outside the municipal limits of the cities / towns.
10. The decision of the company is final and binding on all matters arising out of this warranty.
11. This warranty is issued at Delhi, and courts of Delhi shall have exclusive jurisdiction over matters by following from this warranty. In case of any dispute, arising out of the same shall be settled by an Arbitrator, in accordance with the provision of Arbitration and conciliation ACT, 1996.

WARRANTY CARD

Model No. CO-190

Serial No.

C.M.No. Date of Sale.

Owner's Name and Address.

Tested By. Remarks.

AUTHORIZED DEALER/FRANCHISEE



**MAHARAJA
SERVICE APP**

www.maharajawhiteline.com

Follow us on :

Marketed by:

Groupe SEB India (P) Ltd.
C-67, 3rd Floor, DDA Sheds, Okhla Phase 1, New Delhi-110020, India

For customer feedback and complaints, please contact:

Service Executive: Groupe SEB India (P) Ltd.
C-67, 3rd Floor, DDA Sheds, Okhla Phase 1, New Delhi-110020, India
Tel : 011-43684999, 8860555777
e-mail : maharajacare@groupeseb.com

'Maharaja Whiteline' is registered trademark of Groupe SEB India Pvt Limited.

COMPANY'S AUTHORIZED PRICE LIST FOR SPARES AVAILABLE WITH SERVICE FRANCHISEE

MAHARAJA[®] — WHITELINE —

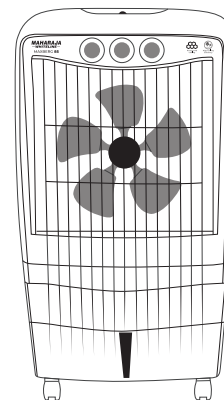

**1 YEAR
WARRANTY**

MAXBERG 85
Desert Air Cooler

INSTRUCTION MANUAL

How To Install And Operate Product

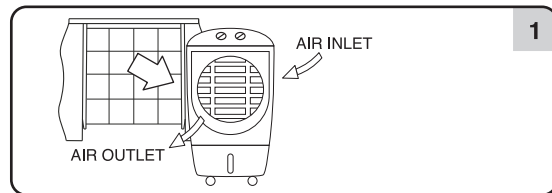

INSTALLATION

1. Place your cooler atleast 10cm away from wall or any other obstruction. The cooler should be placed near a window / door to allow fresh air.
2. Always ensure that there is another open window / door through which warm air can escape from the room. Constant air changes is very essential for fresh air cooling by your cooler.
3. Plug in the mains cord of your cooler to a wall socket. Ensure the plug is properly earthed and is in 'OFF' position while plugging.

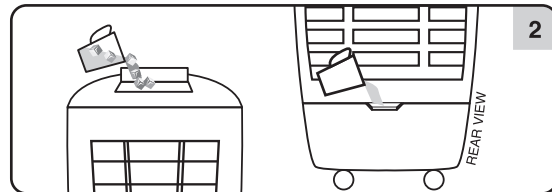

FILLING OF WATER

Fill water tank of the cooler with water through the water inlet door / ice lid. It is advisable to use tumbler to fill the water to avoid spillage. (Ensure the power point is 'OFF' while filling water)

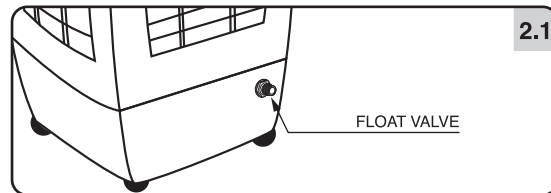

AUTOFILL

Float valve facility is available. Make provision for automatic water filling to the cooler. Ensure proper connection of water inlet pipe into the float valve to avoid leakage.

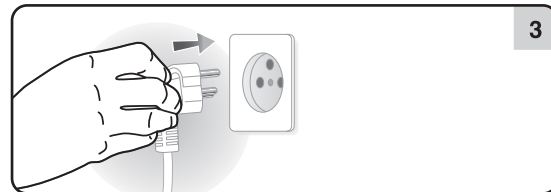

POWER SUPPLY

Ensure that your cooler is plugged into specified voltage / frequency outlet only. Switch 'ON' the power supply.

How To Install And Operate Product

CONTROLS:

- A. Set the "SPEED" knob to desired level viz. HIGH, MED, LOW of air delivery. If you want to use the cooler in COOL mode, set the "COOL" knob to "ON" position to obtain continuous chilled air.
- B. If you need a focused blast of cool air, wait for the air blast to focus in the direction you desire and then turn the "SWING" knob to "OFF" position.
- C. If you want to focus air blast in 'UP' & 'DOWN' direction, set the 'HORIZONTAL LOUVER' to desired direction.



Safety Precautions

- Always disconnect mains supply before filling water.
- Do not overfill the cooler.
- Do not try to fill the water into the cooler rapidly particularly when there is water in the tank.
- Do not move the cooler when there is water in the tank.
- Always disconnect mains before opening filter net or panels.
- Be particularly careful when using the cooler near curtains. Keep it at a safe distance from the curtains.

Care & Maintenance

CARE

1. When the cooler is not being used, make sure that all the switches are in the 'OFF' Position.
2. Operate all controls gently.
3. Do not wipe the cooler with corrosive chemicals, scrubbing powder or NC thinner as they will damage the finish.
4. Before moving or relocating the cooler ensure that the mains cord is unplugged and that the water tank is empty.
5. Do not keep heavy weight on top of the air cooler.
6. Do not add any bleaching agents to the water in the tank.

MAINTENANCE

1. Periodic maintenance helps to keep your air cooler in good condition.
2. We recommend draining the unit and cleaning the evaporative pads.
3. Stop the cooler and disconnect plug from the main socket, before cleaning.
4. Clean the evaporative pad using the house spray until the dust is removed, which would otherwise decrease the effectiveness of the cooler.
5. Replace the woodwool pad every year & Honeycomb pad every three years for efficient cooling.
6. After the summer season, ensure that the water is drained out completely from the tank.

Cleaning of cooler by draining the water

To drain the left over water from the tank pull to remove the drain plug given at the bottom side of the tank. After draining, push to fix the drain plug properly.

It is advisable to drain water on regular basis for better performance & longer life of pads.

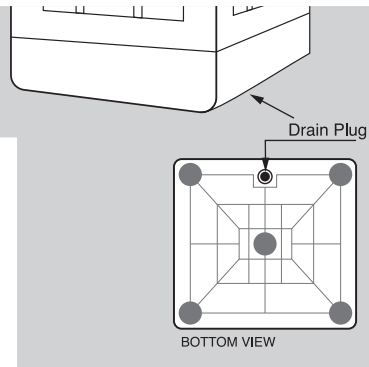

Trouble Shooting

Trouble	Cause	Remedy
Less Cooling	Pump is switched 'OFF'	Switch 'ON' the Pump
	No air circulation	Ensure cross ventilation
Water Leakage	Drain Plug is displaced	Ensure that the drain plug is positioned properly
	Grill lock is disengaged	Relock the grill
	Cooling pad is sagged	Change the cooling pads
Fan not working	Speed switch is turned 'OFF'	Switch 'ON' the fan by selecting the required speed
	Loose contact at socket	Rectify faulty wiring / Socket in the house
	Switch or Motor Malfunctioning	Call customer care help line
Sock on cooler	Device malfunction	Call customer care help line

Electrical Wiring Diagram

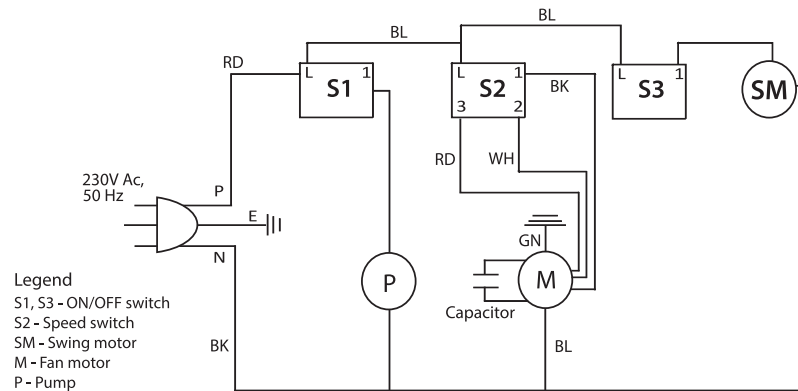

Warranty Terms And Conditions

The appliance is warranted for 1 year against all manufacturing defects. This warranty will not cover damages due to accident, mishandling or non-compliance with the instructions given in the instruction manual.

1. Warranty is valid only if this card is duly signed and stamped by our dealer and is produced along with the original customer's copy of the purchase bill.
2. Warranty period starts from the date of purchase from our authorised dealer.
3. The appliance has to be used with normal care and in accordance with instructions for use recommended by the company, as enumerated in the instruction manual.
4. The appliance should not be repaired, tampered or altered by any agency or person other than an authorised company personal or their service centres.
5. The warranty shall not apply to replacement parts such as main cords.