

11. The warranty shall not apply to replacement parts such as Carbon Brushes, Lid, Rubber Ring, Coupler, Shaft Blade, Bush Handle & Main Cords.
12. The customer is responsible for bringing the defective product to the service centre/ manufacturer for servicing & collecting the same at his/ her own cost.
13. Under the terms of warranty, installation, free service will be provided only within the municipal limits of the cities/towns where the company has its branches or authorized representatives. Service outside the municipal limits specified above will be provided after charging the actual to and fro traveling and incidental expenses, as prevailing from time to time.
14. The decision of the company is final and binding on all matters arising out of this warranty.
15. This warranty is issued at Delhi, and courts at Delhi shall have exclusive jurisdiction over matters by or following from this warranty. In case of any dispute, arising out of this the same shall be settled by an Arbitrator, In accordance with the provisions of Arbitration and conciliation Act, 1996.

WARRANTY CARD

Model No. JE-106 Serial No.

C.M.No. Date of Sale.

Owner's Name & Address.

.....

Tested By. Remarks.

AUTHORIZED DEALER/FRANCHISEE

COMPANY'S AUTHORIZED PRICE LIST FOR SPARES AVAILABLE WITH SERVICE FRANCHISEE



**MAHARAJA
SERVICE APP**

www.maharajawhiteline.com

Follow us on:



ISO 9001:2015
Certified Company

Marketed by: Groupe SEB India (P) Ltd. C-67, 3rd Floor,
DDA Sheds, Okhla Phase 1, New Delhi-110020, India

QUALITY CONTROL NO: HP/ 14/ 001/ 0081

For customer feedback and complaints, please contact:

Service Executive : Groupe SEB India (P) Ltd. C-67, 3rd Floor,
DDA Sheds, Okhla Phase 1, New Delhi-110020, India
Tel : 8860555777, 011- 43684999
e-mail:maharajacare@groupeseb.com

'Maharaja Whiteline' is registered trademark of Groupe SEB India Pvt Limited.

MAHARAJA[®]

—WHITELINE—

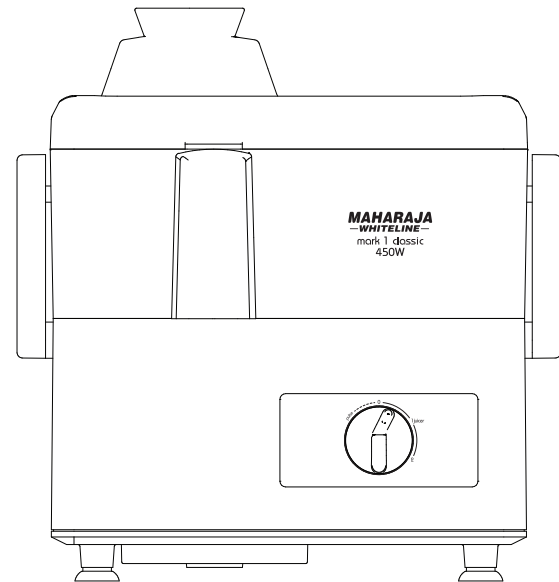

mark 1 classic
Juice Extractor

INSTRUCTION MANUAL

PARTS DESCRIPTION

1. Pusher
2. Feeder Tube
3. Juicer cover
4. Juicer Mesh
5. Middle Body
6. Spout cover
7. Motor coupling
8. Clamp Handle
9. Switch panel
10. Main plug/ Cord
11. Motor Housing

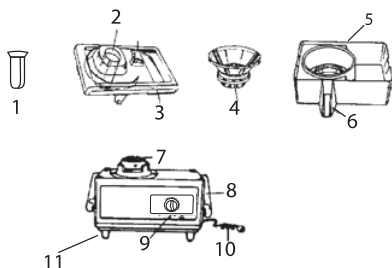

Please read these instructions before operating and retain for future reference.

SAFETY INSTRUCTIONS

1. To protect against electrical shock do not immerse cord, plug or unit in water or any other liquid.
2. Close supervision is necessary when any appliance is operated near children.
3. Unplug unit from outlet when not in use and before putting on or taking off any parts to clean.
4. Do not operate any appliance with a damaged cord or plug, or if appliance malfunction or is damaged in any manner.
5. Do not use outdoors. This appliance is for household use only.
6. Do not allow cord to hang over edge of table or counter, or touch hot surfaces.
7. Do not place unit on or near a hot gas or electric burner or a heated oven.
8. Do not leave appliance unattended. Do not use appliance for other than its intended use.
9. Do not use abrasive cleaners or scouring pads on appliance.
10. The use of attachment not recommended or sold by the manufacturer may cause fire, electric shock or injury.
11. The appliance is not to be operated without the cover locked in place by the securing clamps. NEVER OPERATE UNIT UNLESS IT IS FULLY ASSEMBLED.
12. Be sure to turn switch to OFF position after each use of your juicer. Make sure the motor stops completely before disassembling.
13. Do not put fingers or other objects into juicer cover while it is in operation. If food becomes lodged in opening use food pusher or another piece of fruit or vegetable to push it down. If this doesn't work turn the motor off, unplug unit, then disassemble juicer to remove remaining food.
14. Make sure all parts are firmly attached to Motor Housing unit.
15. Do not overload appliance or use excessive force to press food through the feeder tube.
16. Sharp Blade-always use food pusher.

OPERATING INSTRUCTIONS

Please note that safety interlock prevents unit from operating unless protective cover is clamped securely in place. 1. Before plugging unit into power source, make sure that the switch is OFF and the securing clamps unit into are safely locked.

2. Wash fruits and vegetables well. Cut fruits into small pieces so they can easily fit into the feeder tube.

(A) The juicer extractor cannot process bananas, peaches, apricots, mangoes, Papayas, etc. Because no juice can be squeezed from those fruits.

(B) The juicer extractor cannot process coconut or other hard items because they may damage the motor and filter.

(C) Peels must be removed from citrus fruits, remove pits from cherries, Prune etc. Before feeding them into the tube.

3. Making sure that the supply voltage is same as indicated voltage on the unit and then plug the cord in the power outlet
4. Switch the power "ON".
5. Insert the prepared fruits into the feeding tube and gently push the plunger containers before continuing to process.
6. When residue or juice cups are full, switch the power "OFF" and empty the containers before continuing to process.
7. After using, switch appliance "OFF" and unplug the unit.

GUIDE FOR EXTRACTING JUICE

1. When making a mix drink, use the softer ingredients first, then the harder ones.
2. Vitamins disappear quickly after extraction of the fruits and vegetables. The juice should be consumed as soon as possible.
3. Apple juicer turns brown too quickly.
4. The pulp can be used as a base for soups, sauces, jams and desserts.
5. This Product is not suitable for citrus juicing.

CLEANING & MAINTENANCE

1. Stop the juicer extractor (position) and unplug the appliance.
2. Remove the lid and the separator unit as well as the grater and filter unit.
3. Remove the pulp from the reservoir and the lid wash both parts.
4. Wash the grater and filter unit in water using a soft brush. To clean the outside of the motor unit, use a damp sponge.
5. This unit must not be immersed in water.
6. Clean the grate and filter unit in water using a soft brush (e.g. tooth brush)
7. Never use bleach or a scouring pad.

TECHNICAL DATA

| | |
|--------------|------------------|
| Wattage | : 450 watts |
| Power supply | : 230 volts/50Hz |

WARRANTY TERMS AND CONDITIONS

Groupe SEB India (P) Ltd. ("Company") warrants to the purchaser of this Product a warranty commencing from the date of purchase and the Company will repair or replace free of charge any part or parts of the product, should the Company be fully satisfied in its sole discretion that the defect/s is/are due to faulty material or defective workmanship only. The Company offers 1 year on product warranty and 2 years on motor warranty. The warranty will be governed by the following clauses:

1. This warranty is valid only if this card is duly signed and stamped by our dealer and is produced along with the original customer's copy of the purchase bill.
2. Warranty period starts from the date of purchase from our authorized dealer only.
3. The Appliance has to be used with all normal care and maintenance and in accordance with instructions for use, recommended by the company, as enumerated in the instruction manual.
4. The Appliance should not be repaired, tampered or altered by any agency or person other than an authorized company personnel or their service centers.
5. The Appliances subject to normal wear & tear, misuse, neglect, accident including technical breakdown etc. or non-compliance of the instructions given in the instruction manual, improper installation is not covered by this warranty.
6. Plastic Parts, which are breakable, are not covered under this warranty.
7. The Appliance is meant for domestic use only.
8. The decision to repair or replacement of parts shall be at the sole discretion of the company. Unless the product part is non-repairable, replacement shall not be provided.
9. Parts repaired or replaced under this warranty are warranted only for the remainder of the original warranty period, that is no fresh warranty period shall commence for the said replace/repaired part.
10. Liability under terms of warranty is limited to the value of the repairs/replacement of the parts found to be defective within the warranty period. All parts that would have to be replaced shall become the property of the company.