

- 7. The appliances subjected to normal wear and tear, misuse, neglect, accident, including technical break down due to non-compliance of instructions given in the instruction manual, improper installation is not covered by this warranty.
- 8. All parts that may have been replaced shall become the property of the company.
- 9. Under the terms of warranty, servicing will be provided at the address registered by the consumer. The turn around time for technician to visit and resolve the complaint may vary, incase the service address is outside the municipal limits of the cities / towns.
- 10. The decision of the company is final and binding on all matters arising out of this warranty.
- 11. This warranty is issued at Delhi, and courts of Delhi shall have exclusive jurisdiction over matters by following from this warranty. In case of any dispute, arising out of the same shall be settled by an Arbitrator, in accordance with the provision of Arbitration and conciliation ACT, 1996.

WARRANTY CARD

Model No.
Serial No.
C.M.No. **Date of Sale.**
Owner's Name and Address.

Tested By. **Remarks.**

AUTHORIZED DEALER/FRANCHISEE

COMPANY'S AUTHORIZED PRICE LIST FOR SPARES AVAILABLE WITH SERVICE FRANCHISEE



MAHARAJA SERVICE APP

www.maharajawhiteline.com

Follow us on :

Marketed by:

Groupe SEB India (P) Ltd.

C-67, 3rd Floor, DDA Sheds, Okhla Phase 1, New Delhi-110020, India

For customer feedback and complaints, please contact:

Service Executive: Groupe SEB India (P) Ltd.

C-67, 3rd Floor, DDA Sheds, Okhla Phase 1, New Delhi-110020, India

Tel : 011-43684999, 011-33684999,

e-mail:maharajacare@groupeseb.com

MAHARAJA —WHITELINE—

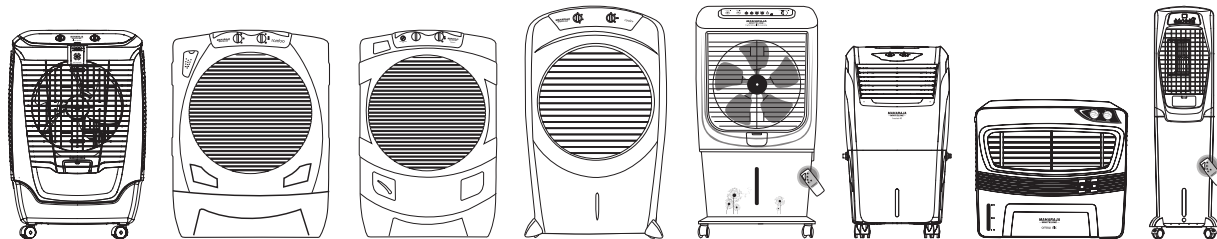

1 YEAR WARRANTY

Air Coolers

INSTRUCTION MANUAL

How To Install And Operate Product

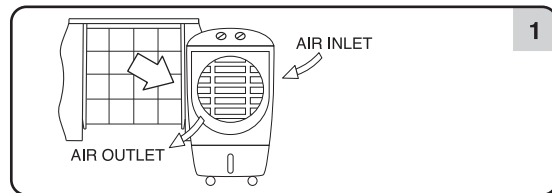

INSTALLATION

1. Place your cooler atleast 10cm away from wall or any other obstruction. The cooler should be placed near a window / door to allow fresh air.
2. Always ensure that there is another open window / door through which warm air can escape from the room. Constant air changes is very essential for fresh air cooling by your cooler.
3. Plug in the mains cord of your cooler to a wall socket. Ensure the plug is properly earthed and is in 'OFF' position while plugging.

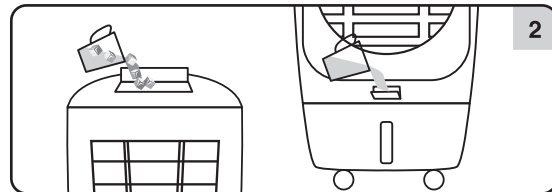

FILLING OF WATER

Fill water tank of the cooler with water through the water inlet door / ice lid. It is advisable to use tumbler to fill the water to avoid spillage. (Ensure the power point is 'OFF' while filling water)

* Rambo , Bravo

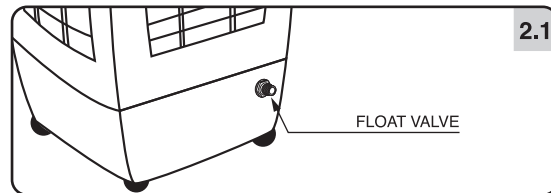

AUTOFILL

Float valve facility is available in selected models*. Make provision for automatic water filling to the cooler. Ensure proper connection of water inlet pipe into the float valve to avoid leakage.

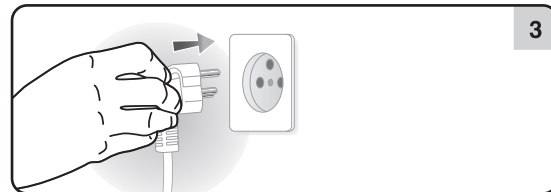

POWER SUPPLY

Ensure that your cooler is plugged into specified voltage / frequency outlet only. Switch 'ON' the power supply.

How To Install And Operate Product

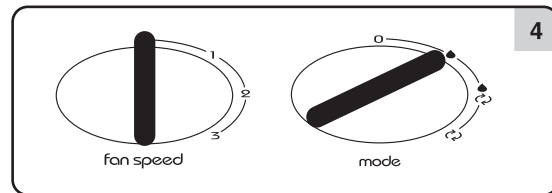

CONTROL

Switch on the pump of the cooler by first putting the control knob in cool position but keeping the air flow control in 'OFF' position. Wait for 5 minutes for the pad to get wet properly.**

** Not applicable for window cooler

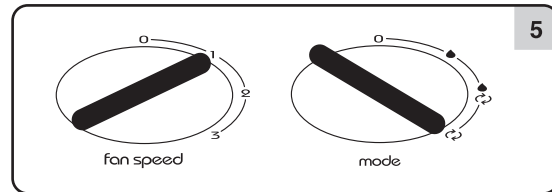

CONTROL

Set the air cooler to 'ON' position. Set the FAN SPEED knob to desired level that is 1, 2 or 3 for air delivery. If you want to use the cooler in COOL mode, set the MODE knob to swing(↔) position to obtain continuous horizontal oscillation of air. Wait for the blast to focus in the direction you desire and then turn the MODE knob to '0'.

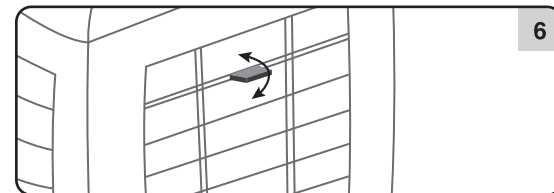

LOUVERS MOVEMENT

Adjust horizontal louvers manually as desired.

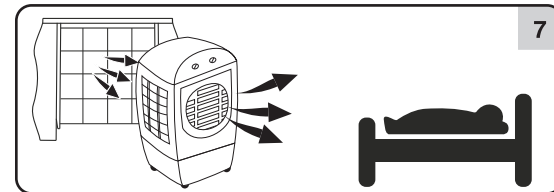

Keep the doors & windows open for optimum cooling performance. Always keep the cooler in front of an open window.

How To Operate Remote Control Model

CONTROLS

A. POWER ON/OFF: Press power button to turn on the unit. Only power LED will glow and remaining will shut off. Press power button again to turn off the unit.

B. SPEED: After plugging the cooler into the specified voltage, press the speed button to start & select the fan speed level in the following sequence High-Medium-Low & High-Low Specified LED will glow according to your selection.

C. SWING: In order to spread the air around the room press swing button. LED will glow when you press the swing button.

D. TIMER (For Remote models only): Press the timer button to set the desired timing level, the range of the timer is 1-7 hours. Specified LED will glow according to set time. No LED glow means, it is in continuous mode.

E. PUMP: In order to increase the cooling, press cool button. Ensure that the tank of the cooler is filled with water at required level before pressing the cool button. Specified LED will glow, when you press the cool button.

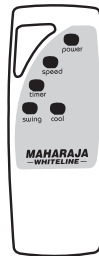

SAFETY PRECAUTIONS

- Always disconnect mains supply before filling water.
- Do not overfill the cooler.
- Do not try to fill the water into the cooler rapidly particularly when there is water in the tank.
- Do not move the cooler when there is water in the tank.
- Always disconnect mains before opening filter net or panels.
- Be particularly careful when using the cooler near curtains. Keep it at a safe distance from the curtains.

Care & Maintenance

CARE

1. When the cooler is not being used, make sure that all the switches are in the 'OFF' Position.
2. Operate all controls gently.
3. Do not wipe the cooler with corrosive chemicals, scrubbing powder or NC thinner as they will damage the finish.
4. Before moving or relocating the cooler ensure that the mains cord is unplugged and that the water tank is empty.
5. Do not keep heavy weight on top of the air cooler.
6. Do not add any bleaching agents to the water in the tank.

MAINTENANCE

1. Periodic maintenance helps to keep your air cooler in good condition.
2. We recommend draining the unit and cleaning the evaporative pads.
3. Stop the cooler and disconnect plug from the main socket, before cleaning.
4. Clean the evaporative pad using the house spray until the dust is removed, which would otherwise decrease the effectiveness of the cooler.
5. Replace the woodwool pad every year & Honeycomb pad every three years for efficient cooling.
6. After the summer season, ensure that the water is drained out completely from the tank.

Care & Maintenance

Cleaning of cooler by draining the water

To drain the left over water from the tank pull to remove the drain plug given at the lower back side / bottom side of the tank. After draining, push to fix the drain plug properly.

It is advisable to drain water on regular basis for better performance & longer life of pads.

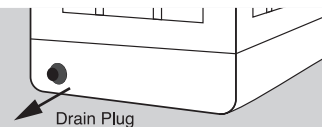

Trouble Shooting

Trouble	Cause	Remedy
Less Cooling	Pump is switched 'OFF'	Switch 'ON' the Pump
	No air circulation	Ensure cross ventilation
Water Leakage	Drain Plug is displaced	Ensure that the drain plug is positioned properly
	Grill lock is disengaged	Relock the grill
	Cooling pad is sagged	Change the cooling pads
Fan not working	Speed switch is turned 'OFF'	Switch 'ON' the fan by selecting the required speed
	Loose contact at socket	Rectify faulty wiring / Socket in the house
	Switch of Motor Malfunctioning	Call customer care help line
Sock on cooler	Device malfunction	Call customer care help line

How To Assemble The Leg & Castor Wheel

Slide the Leg / Castor into the tank as shown & fasten the screw both side. Insert the shaft of the wheel into the leg & tank recess & ensure it is fit firmly.

Only For These Models:
(Hybridcool Pro 65, Dio 20 Ltr, Coolz Plus)

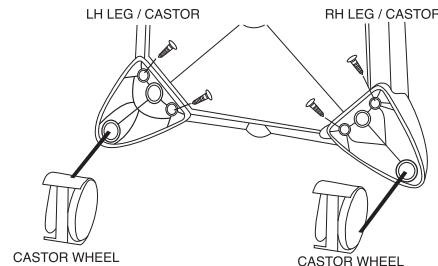

Instructions For Fitting Mosquito Repellent Refill In The Anti-mosquito Chamber

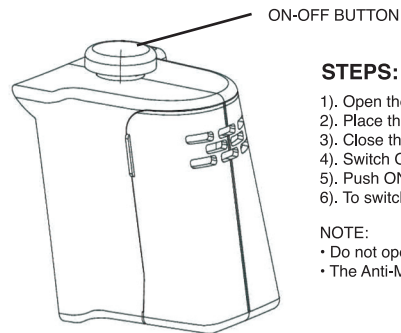

STEPS:

- 1). Open the Front Cover by pulling it out
- 2). Place the liquid repellent refill in the housing (Illustrated below)
- 3). Close the front cover
- 4). Switch ON the air cooler
- 5). Push ON button, to switch ON the device
- 6). To switch OFF the device, push the button again

NOTE:

- Do not operate the device without switching ON the air cooler
- The Anti-Mosquito chamber is compatible with refills available in the market

ILLUSTRATION:

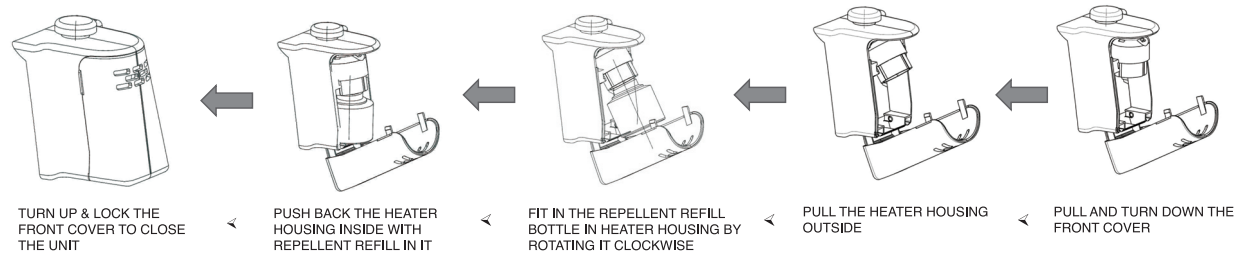
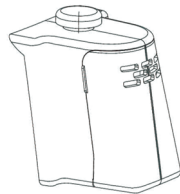

Wiring Diagrams

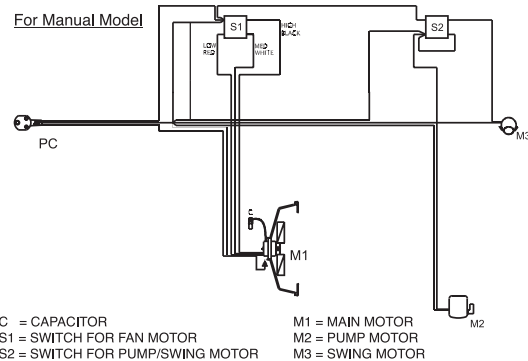

Supply Voltage: 230V AC / 50 Hz

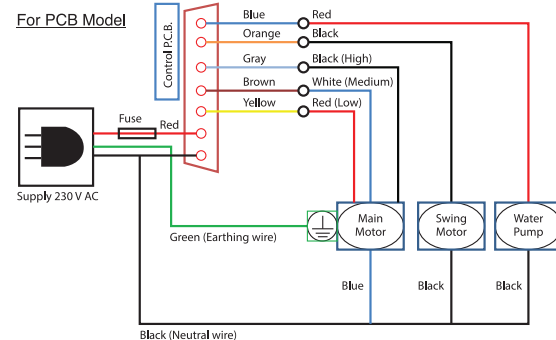

Warranty Terms And Conditions

The appliance is warrantied for 1 year against all manufacturing defects. This warranty will not cover damages due to accident, mishandling or non-compliance with the instructions given in the instruction manual.

1. Warranty is valid only if this card is duly signed and stamped by our dealer and is produced along with the original customer's copy of the purchase bill.
2. Warranty period starts from the date of purchase from our authorised dealer.
3. The appliance has to be used with normal care and in accordance with instructions for use recommended by the company, as enumerated in the instruction manual.
4. The appliance should not be repaired, tampered or altered by any agency or person other than an authorised company personal or their service centres.
5. The warranty shall not apply to replacement parts such as main cords.
6. Plastic and glass parts, which are breakable, are not covered under this warranty.